

Medical Staff Office Locations

Upland Hills Health Clinics

Upland Hills Health Specialty Clinic – Hospital Campus

800 Compassion Way, Dodgeville, WI 53533 | 608.930.8000

Dodgeville Medical Center of Upland Hills Health

1204 Joseph Street, Dodgeville, WI 53533 | 608.935.2308

Mineral Point Medical Center of Upland Hills Health

104 High Street, Mineral Point, WI 53565 | 608.987.2346

Upland Hills Health Barneveld Clinic

103 Quail Ridge Drive, Barneveld, WI 53507 | 608.924.1088

Upland Hills Health Highland Clinic

723 N. Main Street, Highland, WI 53543 | 608.929.4518

Upland Hills Health Montfort Clinic

202 W. U.S. Highway 18, Montfort, WI 53569 | 608.943.6308

Upland Hills Health Mount Horeb Clinic

North Cape Suites, 1809 Springdale Street
Mount Horeb, WI 53572 | 608.437.8033

Upland Hills Health Spring Green Clinic

156 W. Jefferson St., Spring Green, WI 53588 | 608.588.2600



Trusted Care. Timeless Compassion.

CLINIC A Upland Hills Health On-Campus Specialty Clinic 608.930.7115

Orthopedics



Melissa Messer,
PA-C
**ORTHOPEDIC
SURGERY**



Dr. Anthony
Villare
**ORTHOPEDIC
SURGERY**



Dr. Bronson
Bomkamp
**GENERAL
SURGERY**



Dr. Jared
Linebarger
**GENERAL
SURGERY**



Dr. Patrick
Ryberg
**GENERAL
SURGERY**

**Ankle/Foot
Surgery**



Dr. Colin Graney
**ANKLE/FOOT
SURGERY**

**Obstetrics
and Gynecology**



Dr. Jenifer
Dankyi
OB/GYN



Dr. Tim
Raichle
OB/GYN

Allergy



Dr. Brad
McClimon
ALLERGY

**Diabetes
Educator**



Michelle Price,
RDN
**DIABETES
EDUCATOR**

Endocrinology



Dr. Kristin Stevenson
ENDOCRINOLOGY

**Ear, Nose,
Throat**



Dr. Tyler
Willman
**EAR, NOSE,
THROAT**

**Pain
Management**



Dr. Thomas Faull
**PAIN
MANAGEMENT**

Clinic D Upland Hills Health Orthopedics 608.930.7115



Dr. Brian Keyes
**ORTHOPEDIC
SURGERY**



Dr. James Prosser
**ORTHOPEDIC
SURGERY**



Dr. Jason Sansone
**ORTHOPEDIC
SURGERY**



Dr. Brian Steffin
**ORTHOPEDIC
SURGERY**

Upland Hills Health Primary Care Office Locations



Dr. Nicole
Altman-Meyers
Barneveld,
Mount Horeb



Dr. Joseph
Berg*
Mount Horeb



Dr. Karen
Berger
Mineral Point



Katie Clerkin
APNP
Barneveld,
Mount Horeb



Melissa
Delaney
PA-C
Mineral Point



Dr. Sarah
Fox
Dodgeville,
Mineral Point



Dr. Gary
Grunow
Dodgeville



Dr. Rachel
Hartline*
Dodgeville,
Highland,
Montfort



Dr. Joshua
Hess
Montfort,
Mineral Point



Megan Keesey
APNP
Barneveld,
Highland



Dr. Jodi McGraw
Barneveld,
Mount Horeb



Rosie Morrey
APNP
Spring Green



Misty Nemitz
APNP
Highland,
Montfort



Dr. Courtney
Reynolds
Dodgeville
Spring Green



Dr. Sarah
Schaaf
Dodgeville,
Mineral Point



Shelby Seman
APNP
Dodgeville



Chelsey
Wallace-Bawden
APNP
Dodgeville,
Mineral Point



Stephanie
Wanek*
APNP
Highland,
Montfort

*Also serving as hospitalist

Upland Hills Health Behavioral Health
1204 Joseph Street, Dodgeville, WI 53533 | 608.935.2308



Allison Geisking, APSW
**BEHAVIORAL HEALTH
COUNSELING**



Barb Kolb, LCSW
**BEHAVIORAL HEALTH
COUNSELING**

Hospitalist



Dr. Sara
Rybarczyk
HOSPITALIST



Dr. Emily Jewell
HOSPITALIST

Emergency (ED)



Dr. Joseph Hansen
**ED MEDICAL
DIRECTOR**

Clinic B SSM Health-Dean Medical Group PRIMARY CARE – FAMILY MEDICINE
Dodgeville 608.935.3301 • Mineral Point 608.987.2391



Dr. Aaron Dunn



Dr. Rachel Keith



Patrick Klein, APNP



Dr. Peter Mullin



John Blabaum, APNP

Clinic C SSM Health-Dean Multi-Specialty Clinic 608.937.7000



Dr. Yamil Arbaje
ONCOLOGY



Dr. Brian
Bachhuber
CARDIOLOGY



Dr. Lauren Craddock
DERMATOLOGY



Dr. Sheng-Jing
Dong
CARDIOLOGY



Richelle Fields,
NP
CARDIOLOGY



Dr. Michael
Frucht
NEUROLOGY



Michele
Gruenenfelder, PA
CARDIOLOGY



Dr. Baher Habeeb
**PULMONARY &
CRITICAL CARE
MEDICINE**



Dr. Jason Isenberg
**ENT (EAR,
NOSE, THROAT)**



Kaitlyn
Israel, PA-C
DERMATOLOGY



Dr. Samantha
Kraemer
UROLOGY



Dr. Lisa M.
Lepeak
ONCOLOGY



Dr. Kelly
McDonnell
CARDIOLOGY



Michelle
Mortensen, PA-C
**SLEEP
MEDICINE**



Dr. Daniel
Petersen
**SLEEP
MEDICINE**



Melissa Pierick,
PA-C
CARDIOLOGY



Lindsay
Resenhoef, NP
**ENT (EAR,
NOSE, THROAT)**



Dr. Norman
Richards
UROLOGY



Dr. Julia Thorsen
**ALLERGY &
IMMUNOLOGY,
PEDIATRICS**



Dr. Maryann
Werz
NEUROLOGY



Dr. Virginia Wilson
RHEUMATOLOGY



Dr. Thomas
Zirkel
PODIATRY

Clinic D Visiting Medical Professionals 608.930.7194



Dr. William Chubb
PODIATRY
Associated
Podiatrists



Dr. Kolette McGary
AUDIOLOGY
Rural Wisconsin
Health Cooperative



Dr. Brenda Rubert
AUDIOLOGY
Rural Wisconsin
Health Cooperative

Additional specialist

Peterson Dermatology
Dr. Jennifer Peterson
1204 Joseph Street, Dodgeville
608.574.5044

Hospital Campus – Clinic Locations

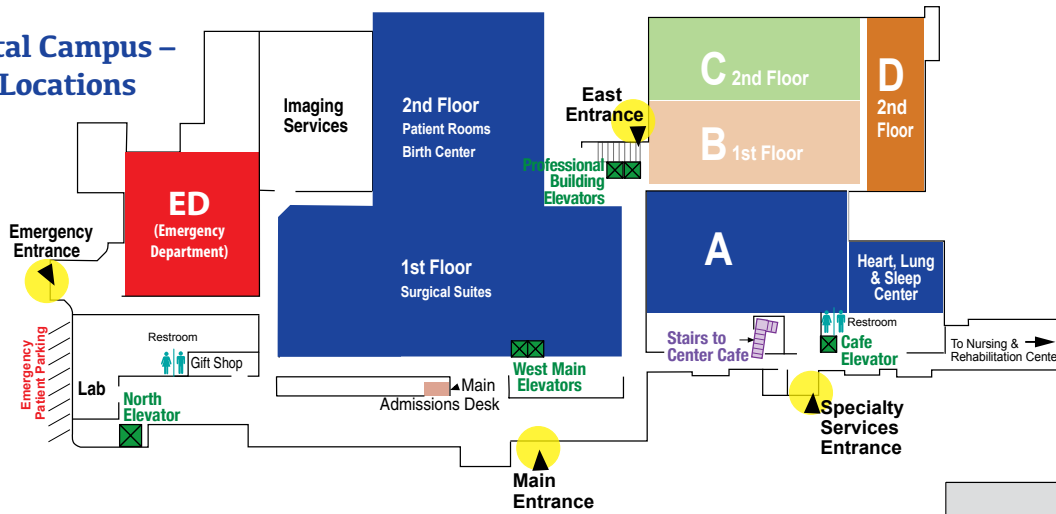

Lower Level

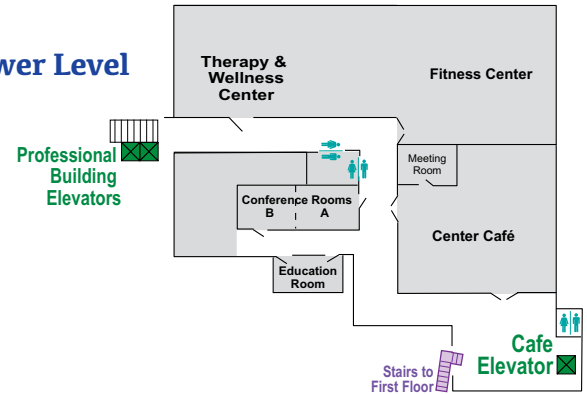

Choosing the Best Entrance for Your Visit

Best entrance to use:

Use the Main Entrance when you have an appointment with:

- Surgery
- Laboratory
- Imaging
- Patient Benefits Specialists
- Visiting a patient in the hospital
- Visiting office personnel

Use the East Entrance when you have an appointment with:

- Therapy & Wellness Center (lower level)
- SSM Health-Dean Medical Group (1st Floor)
- SSM Health-Dean Multi-Specialty Clinic (2nd Floor)
- Visiting Medical Professionals (2nd Floor)

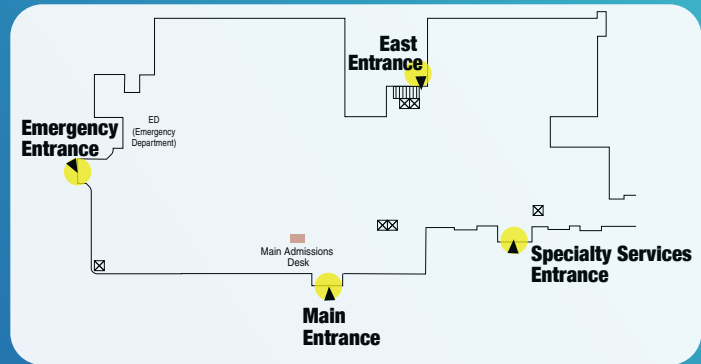

Use the Specialty Services Entrance when you have an appointment with:

- Upland Hills Health Specialists in Clinic A (1st Floor)
- Heart, Lung & Sleep Center

Statement of Nondiscrimination Upland Hills Health complies with applicable federal civil rights laws and does not discriminate on the basis of race, color, national origin, age, disability, or sex.

ATENCIÓN: si habla español, tiene a su disposición servicios gratuitos de asistencia lingüística. Llame al 1-608-930-8000 (TTY: 1-608-930-0008).

LUS CEEV: Yog tias koj hais lus Hmoob, cov kev pab txog lus, muaj kev pab dawb rau koj. Hu rau 1-608-930-8000 (TTY: 1-608-930-0008).